

Winstor

TEKNİK KATALOG

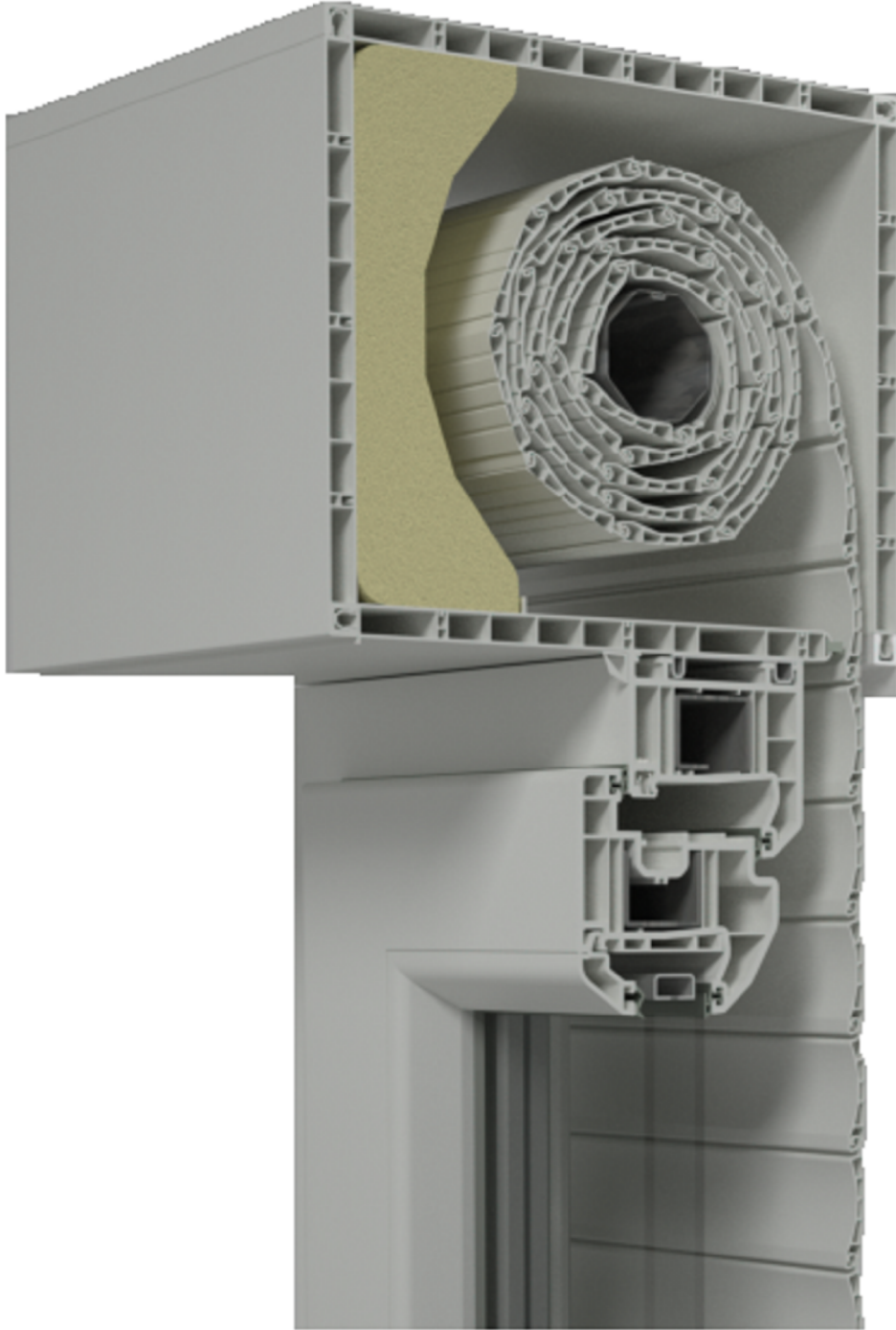

winsa[®]

PVC PENCERE • KAPI • PANJUR SİSTEMLERİ

	sayfa no
SİSTEM TANITIMI	
profiller	1.1
panjur kitleri	1.2
aksesuarlar	1.3
SİSTEM PROFİLLERİ	
panjur kutu 165 mm	2.1
panjur kutu 165x200 mm	2.2
panjur kutu 200 mm	2.3
panjur kutu 200x235 mm	2.4
dikmeler ve panjur lamelleri	2.5 - 2.6
PANJUR KUTUSU DOĞRAMA MONTAJI	3.1 - 3.6
DETAYLAR	4.1 - 4.7

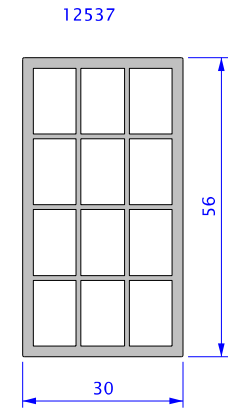
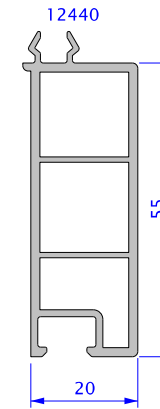
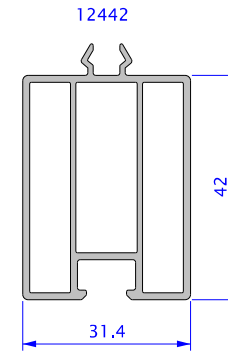
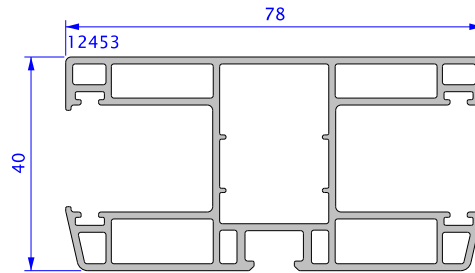
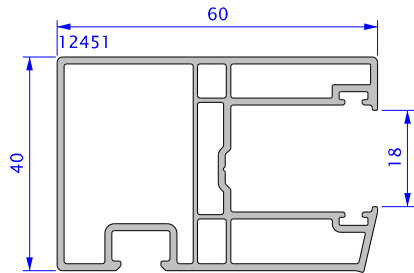
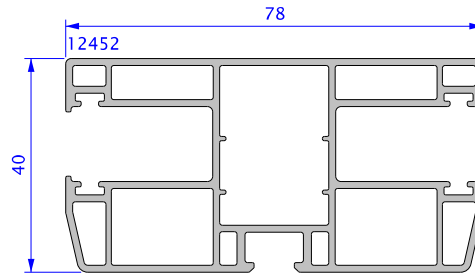
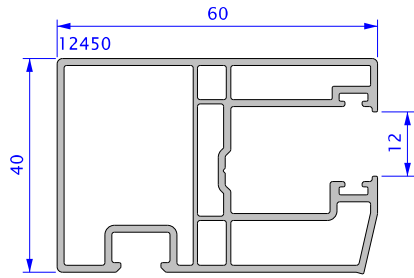
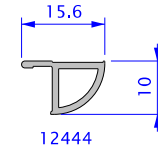
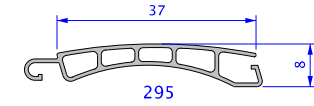
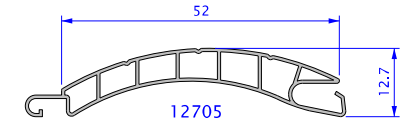
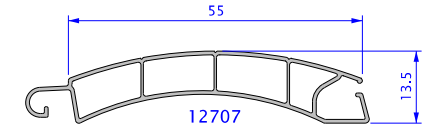
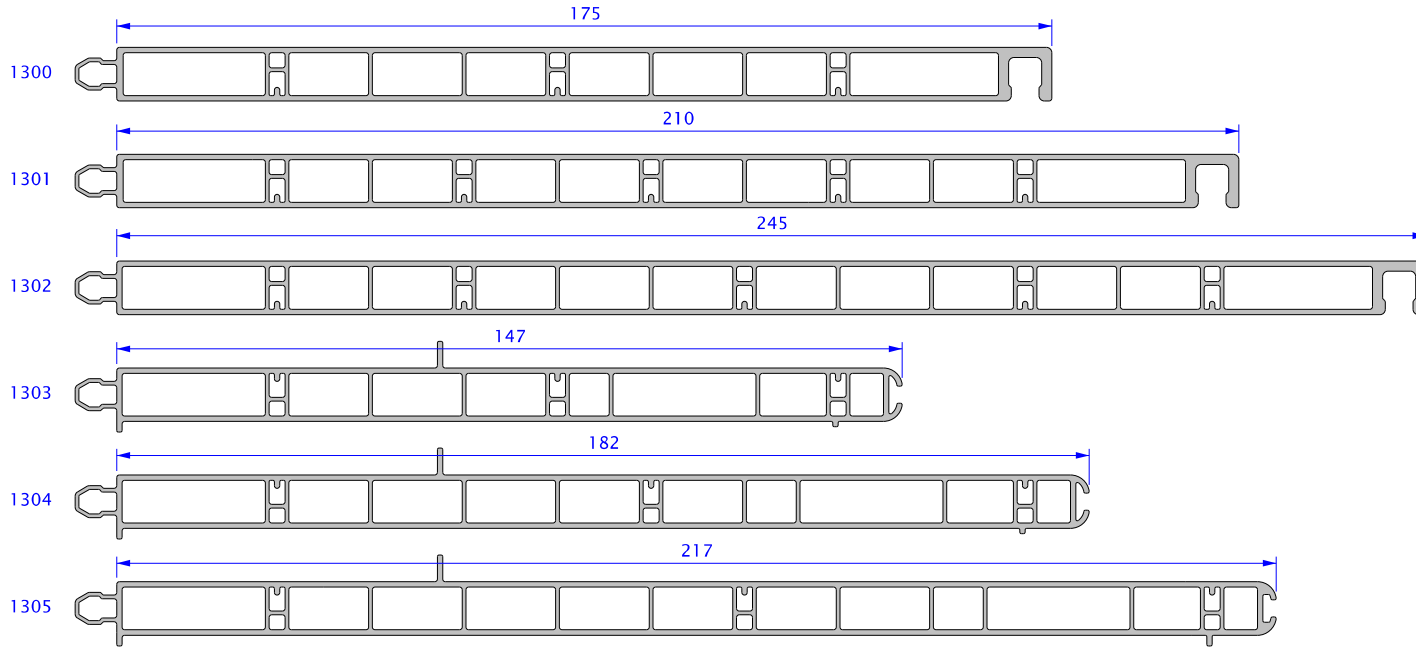

		YAN KİTLER			ORTA KİTLER		
		* Makaralı Orta Kit			* Makaralı Orta Kit		
165 mm	12651 – PANJUR KUTU KİT-1 165 mm	<p>2377x2 2374x2 2375 --> 910x1 --> 911x1 2376x2 887x2</p>	<p>2374x2 13147x2 2376x2 887x2 13485 --> 910x1 --> 911x1</p>	<p>13175 13177x2 887x2</p>	<p>12823 1335x2 1349x2 1331 --> 910x1 --> 911x1</p>	<p>12823 1335x2 1349x2 1332 --> 910x1 --> 911x1</p>	
	13490 – PANJUR KUTU YAN KİT 200 mm	<p>13172x2 13173x2 13170 --> 910x1 --> 911x1 887x2 13171x2</p>	<p>13173x2 13174x2 887x2 13171x2 13486 --> 910x1 --> 911x1</p>	<p>13176 13177x2 887x2</p>	<p>12824 1335x2 1349x2 1331 --> 910x1 --> 911x1</p>	<p>12824 1335x2 1349x2 1332 --> 910x1 --> 911x1</p>	

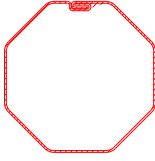
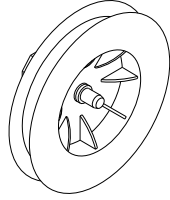
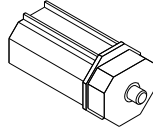
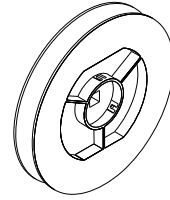
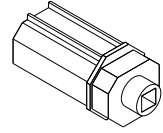
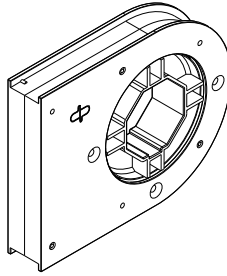
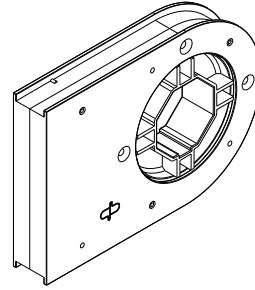
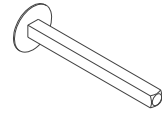
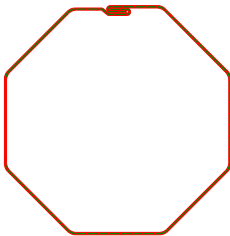
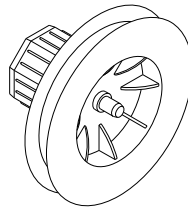
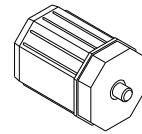
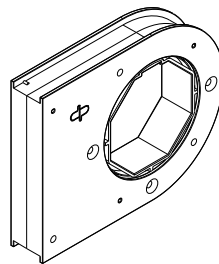
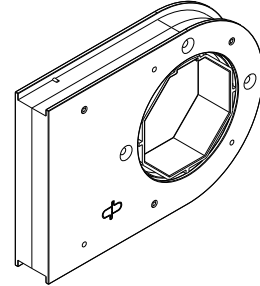
Ø 40 ÇELİK MİL**11727**
--> Ø40**941**
--> 40 mm**13115**
--> 40 mm**2307****2301**
--> 40 mm**13167**
--> 165-40 mm**13153**
--> 200-40 mm**2305****Ø 60 ÇELİK MİL****11728**
--> Ø60**13178**
--> 60 mm**13179**
--> 60 mm**13168**
--> 165-60 mm**13154**
--> 200-60mm

1318



1315



13052
=> Gizli Panjur
uygulamalarında

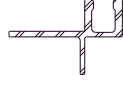

974



13047



13053



934

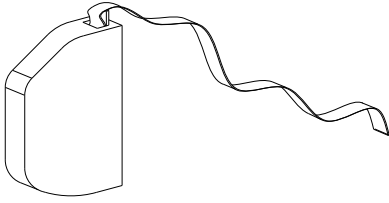

901

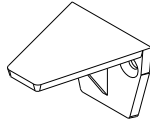

2306

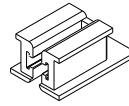

13482
-->13047

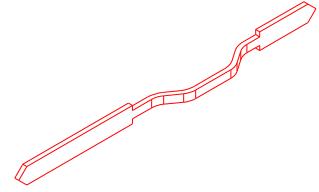

13149
--> 165x200 mm

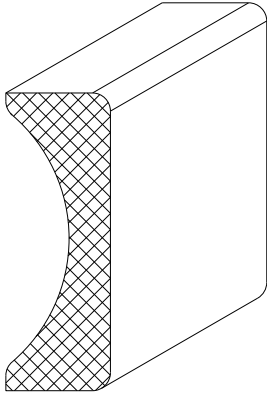

13148
--> 200x235 mm

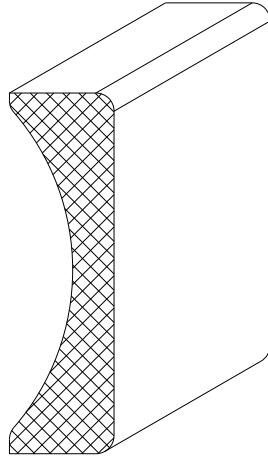

13480
--> 295
12705
12707

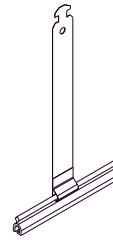

13483
-->295

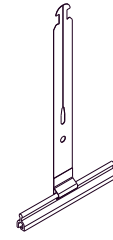

13484
-->12705
12707

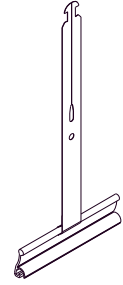

13151
--> 12707

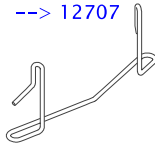

13152
--> 12705

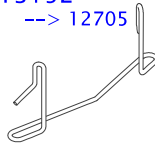

973
--> 295

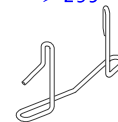

13481

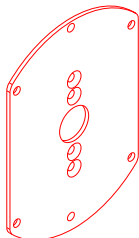

933



13004
-->2.9x9.5



12964
-->48x650



1300 1300 1300 1303

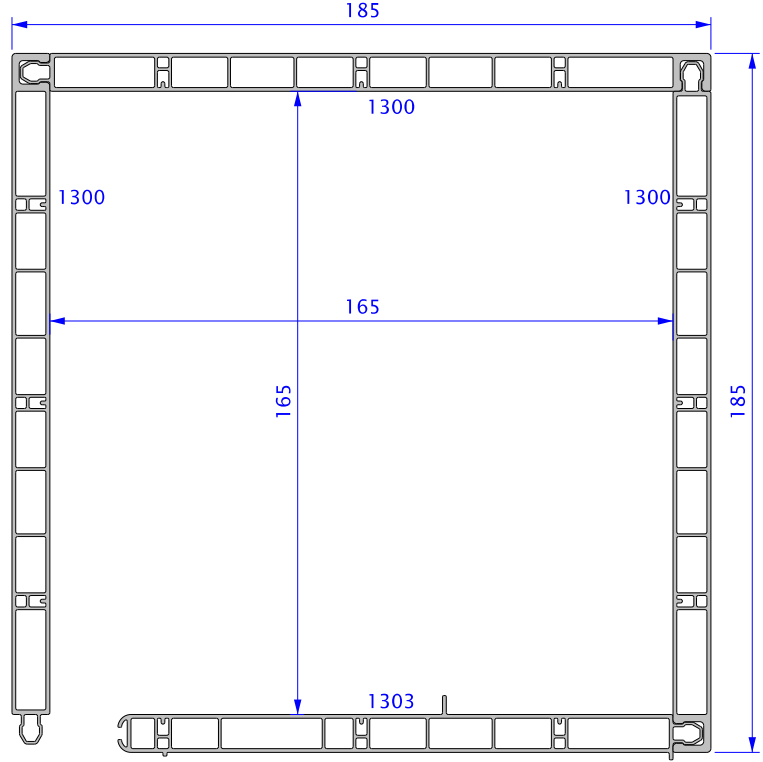
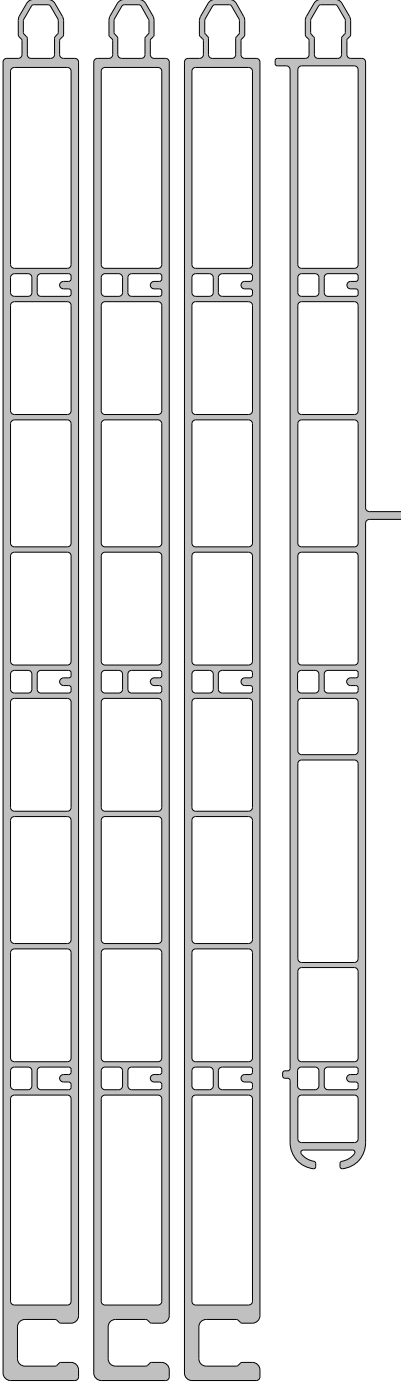

1370-Panjur Kutu 165 mm (Beyaz)

1300	3 adet
1303	1 adet

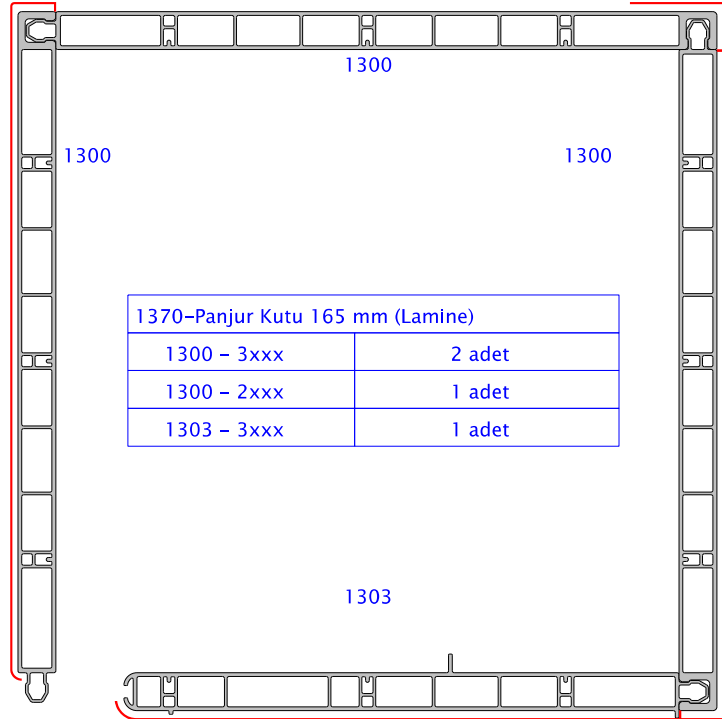

1370-Panjur Kutu 165 mm (Lamine)

1300 - 3xxx	2 adet
1300 - 2xxx	1 adet
1303 - 3xxx	1 adet

1300 1300 1301 1304

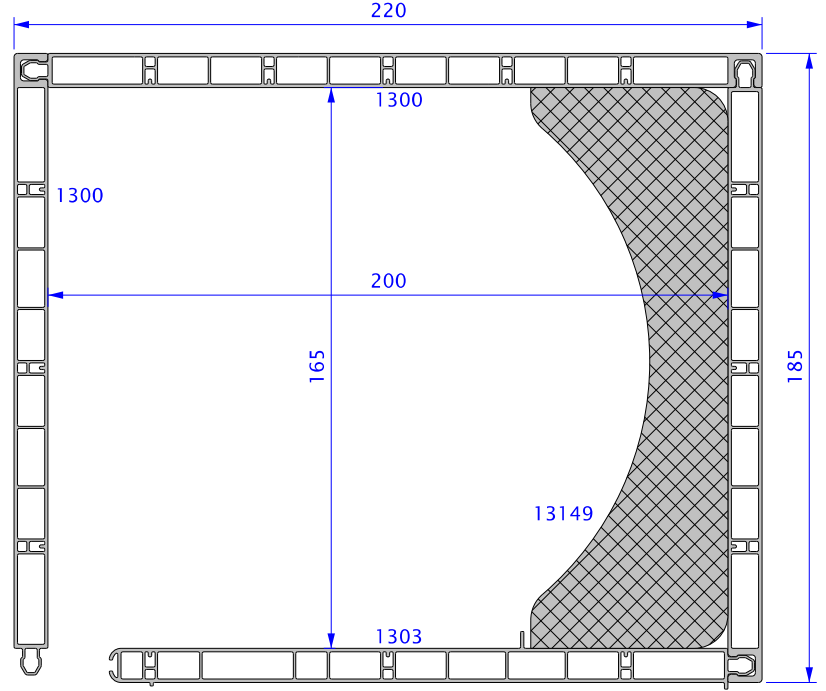
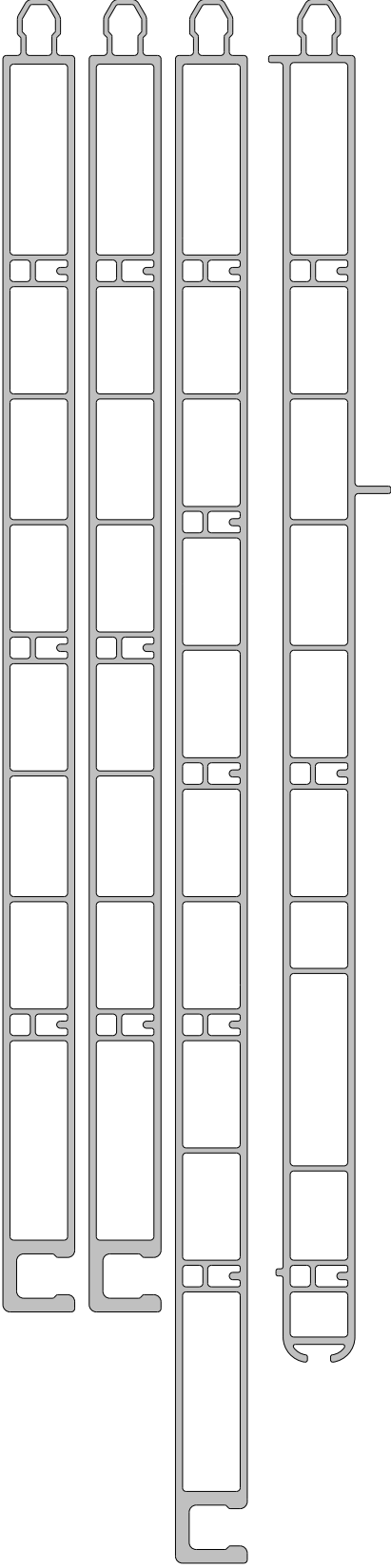

Panjur Kutu 165x200 mm izolasyonlu (Beyaz)

1300	2 adet
1301	1 adet
1304	1 adet

Panjur Kutu 165x200 mm izolasyonlu (Lamine)

1300 - 3xxx	2 adet
1301 - 2xxx	1 adet
1304 - 3xxx	1 adet

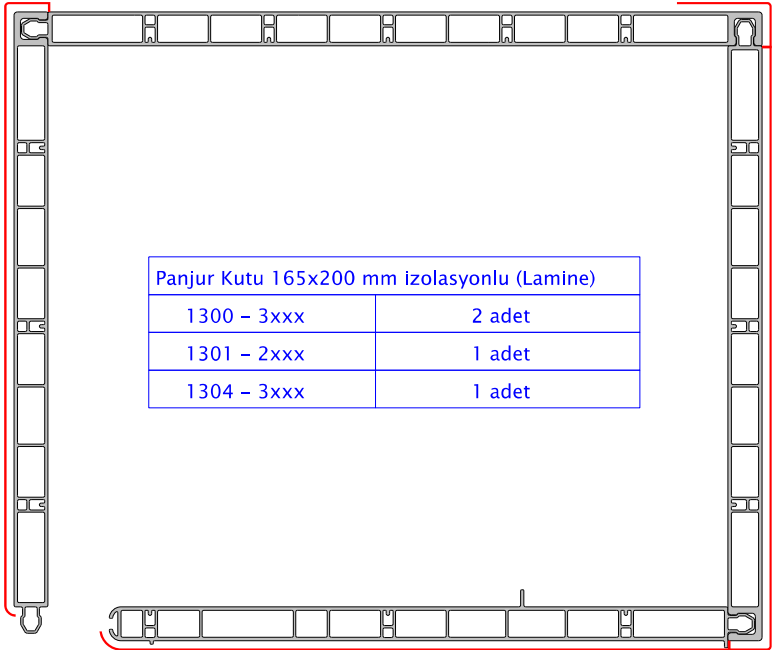

* 165x200 izolasyonlu panjur kutusunun içine "13149-165mm kutu strafor" kullanılmaktadır.

1301 1301 1301 1304

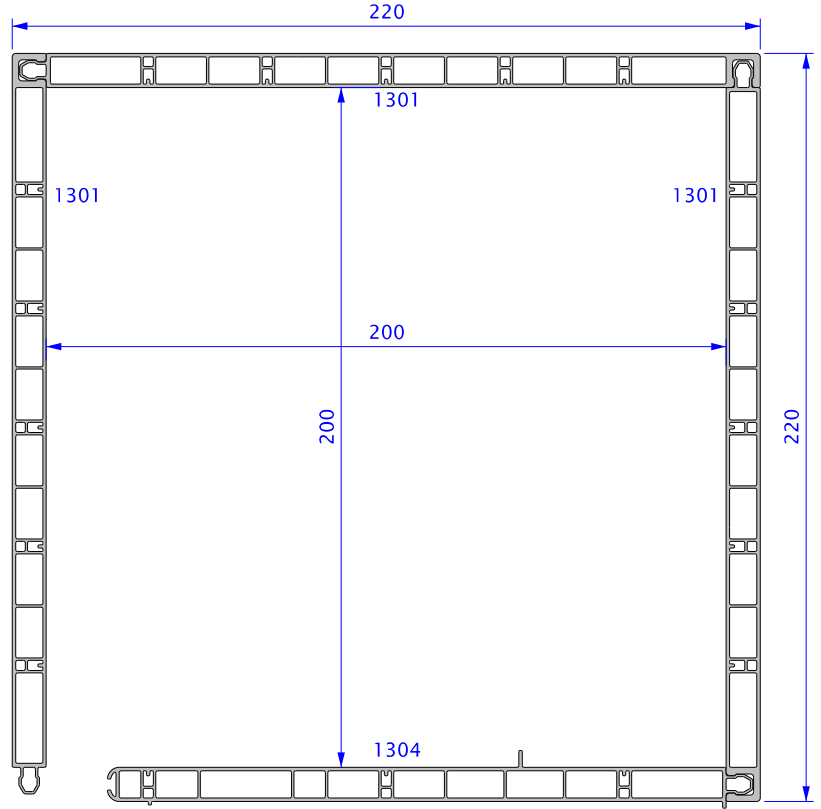
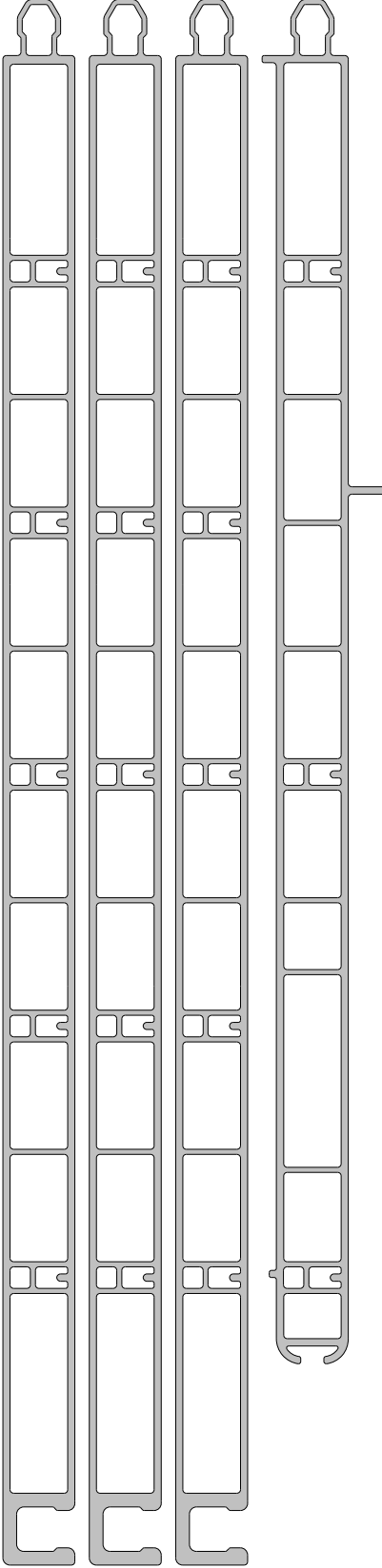

1371-Panjur Kutu 200 mm (Beyaz)	
1301	3 adet
1304	1 adet

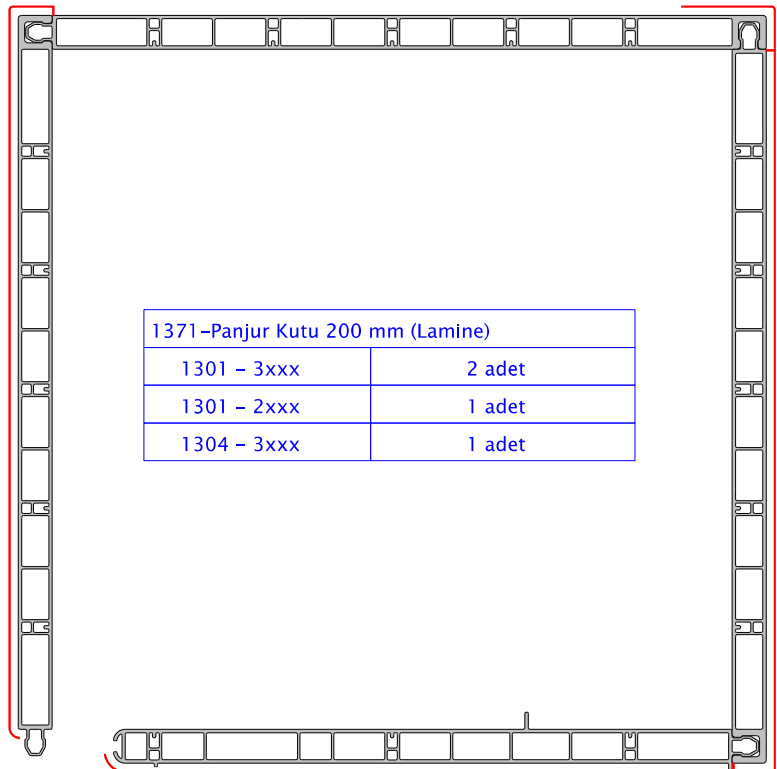

1371-Panjur Kutu 200 mm (Lamine)	
1301 - 3xxx	2 adet
1301 - 2xxx	1 adet
1304 - 3xxx	1 adet

1301 1301 1302 1305

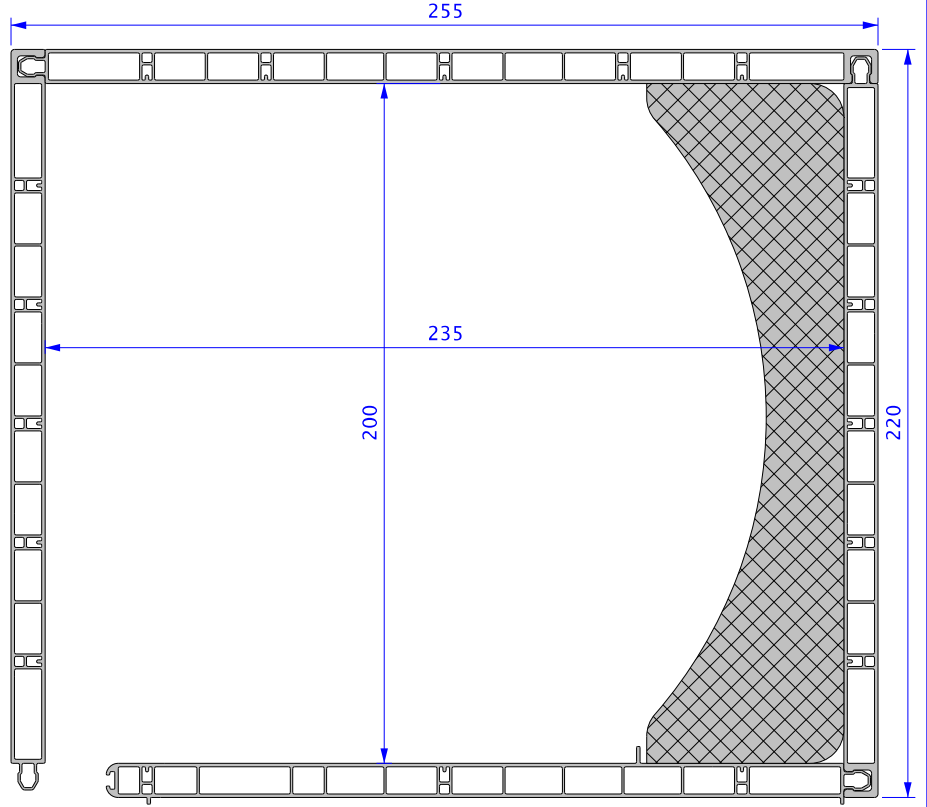
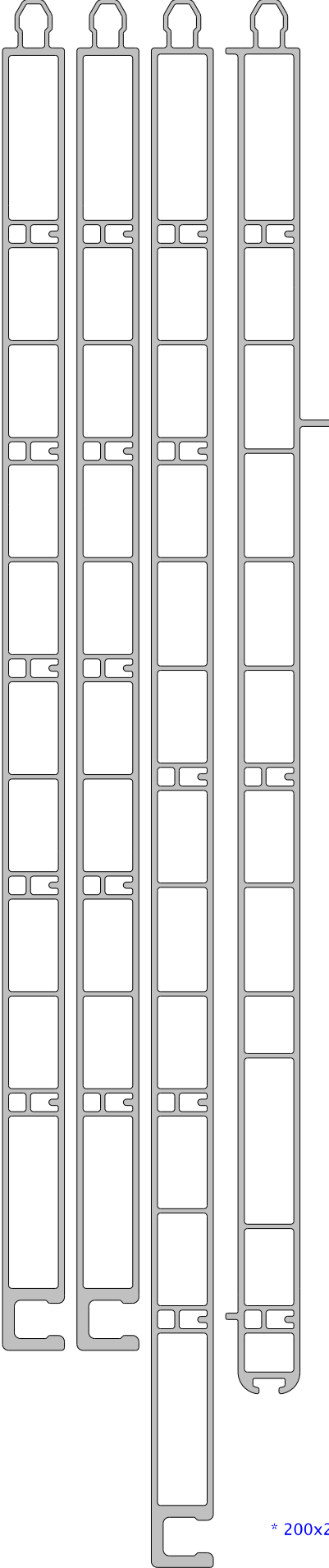

Panjur Kutu 200x235 mm izolasyonlu (Beyaz)

1301	2 adet
1302	1 adet
1305	1 adet

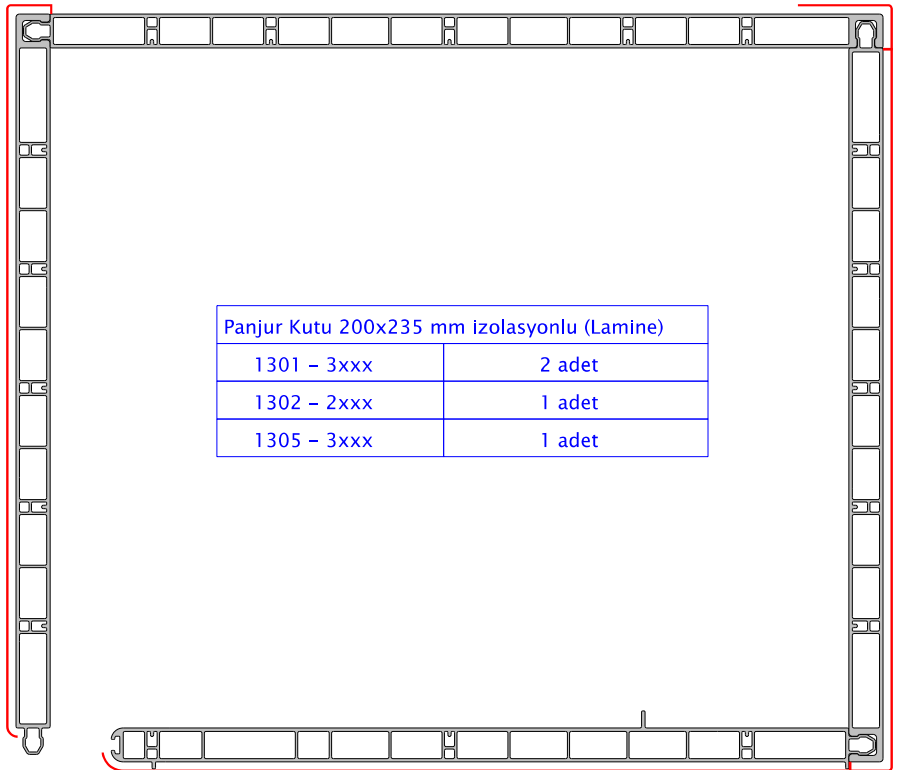

Panjur Kutu 200x235 mm izolasyonlu (Lamine)

1301 - 3xxx	2 adet
1302 - 2xxx	1 adet
1305 - 3xxx	1 adet

* 200x235 izolasyonlu panjur kutusunun iine "13148-200mm kutu strafor" kullanılmaktadır.

295

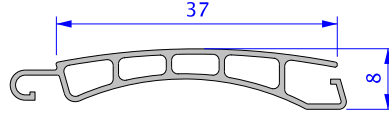

12450

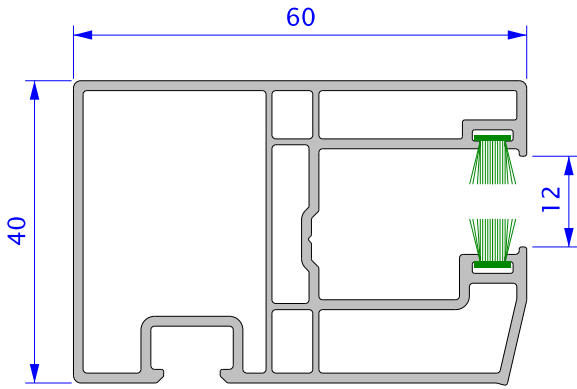

12452

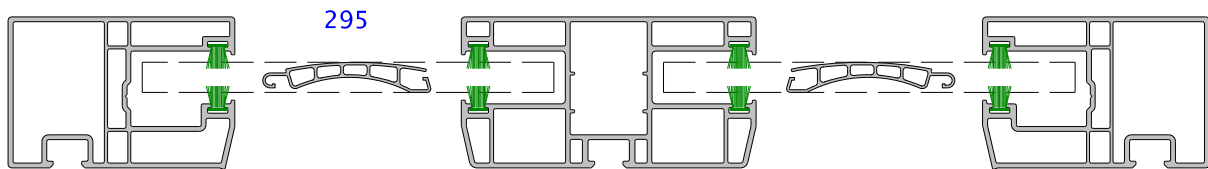
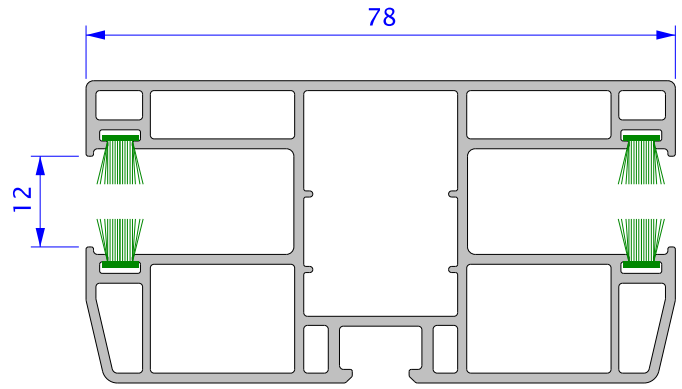

12705

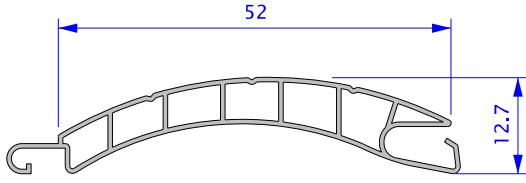

12707

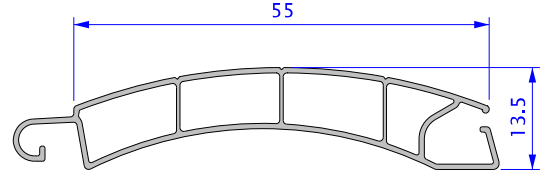

12451

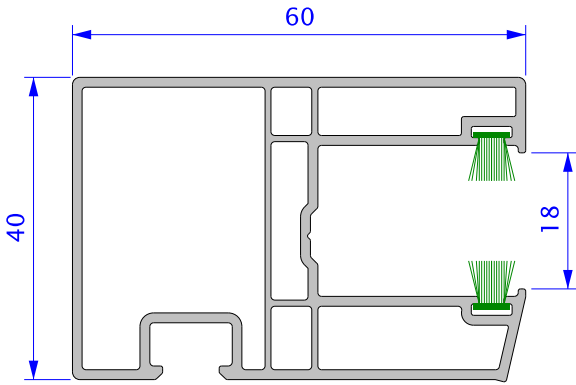

12453

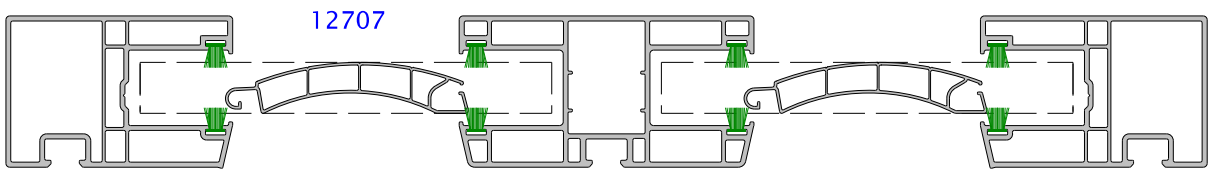
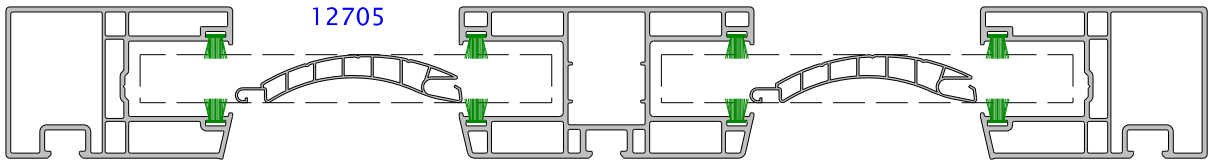
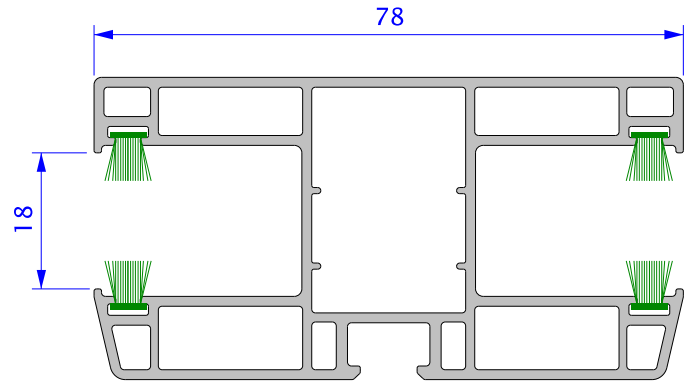

13053 – Panjur Kutu Alt Bağ.Al.

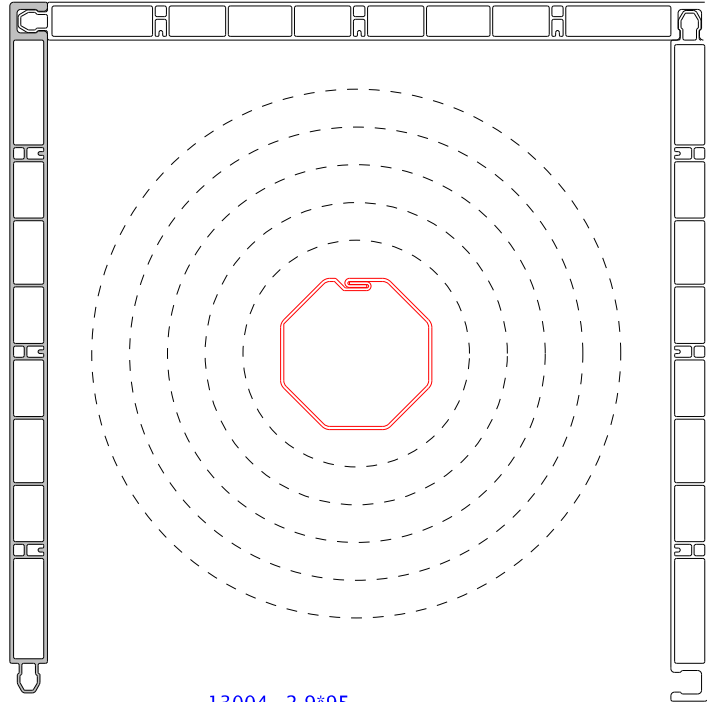
**1**

13004 -2.9*95

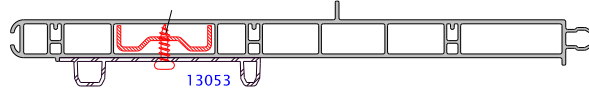

13053

* Alüminyum panj.bağlantı profili (13053), panjur kutu alt kapak profili altındaki tırnak referans alınarak, alüminyum profilden destek sacına (1318) doğru uygun vida ile sabitlenir.

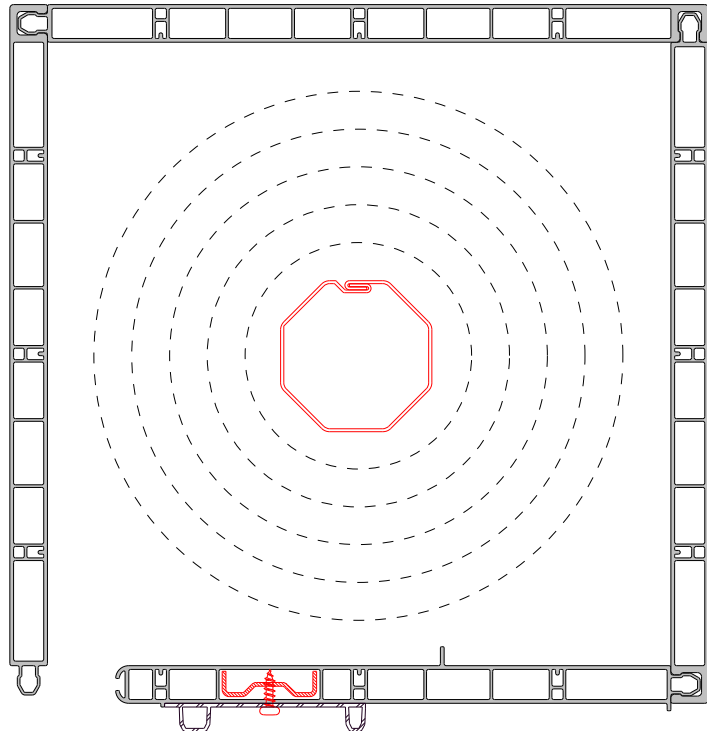
2

* Panjur kutusu toplanır, kutu ile ilgili diğer işlemler tamamlanır.

12444 – Panjur Kutu Oval Kapatma

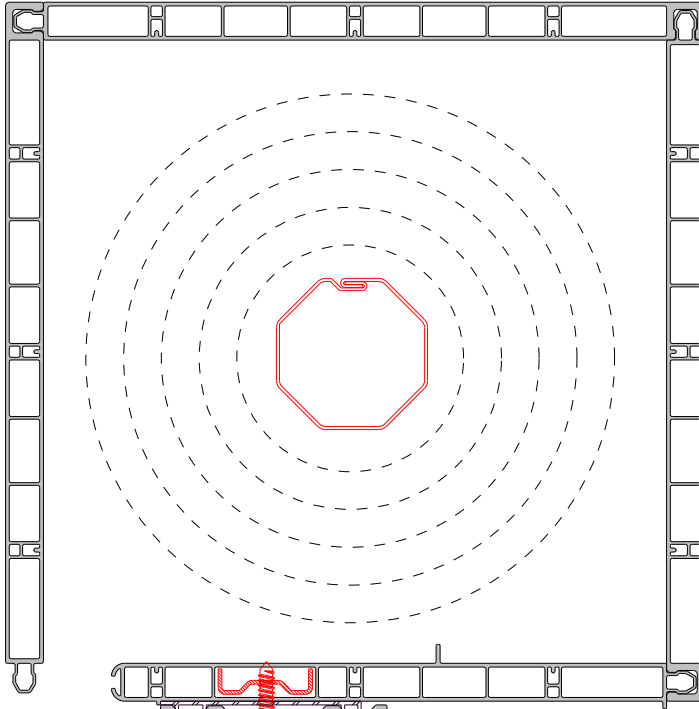

3

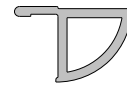

- * Doğrama , panjur kutusundaki alüminyum bağlantı profili, tırnaklarına takılır.
- * Uygun vida ile doğramadan panjur kutusuna sabitleme yapılır.

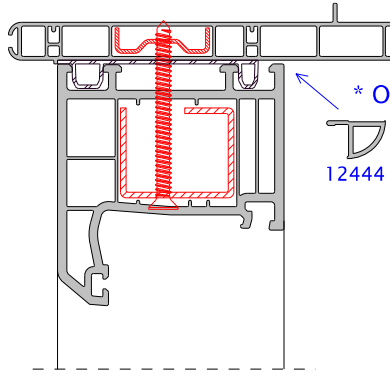

* Oval kapatma profili, kasa ile panjur kutusu arasına yerleştirilir.

12444

4

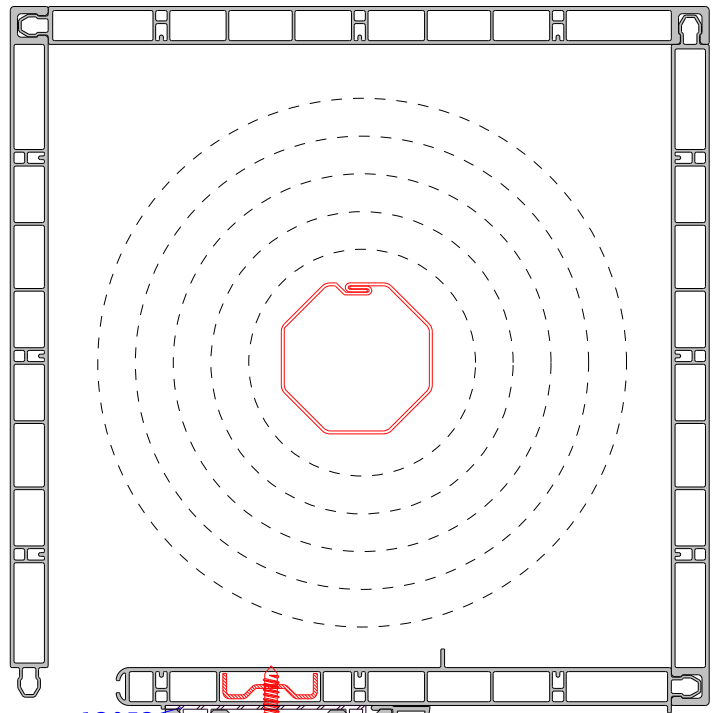

13053

12444

- * Oval kapatma profili, istenirse silikon ya da yapıştırıcı ile sabitlenebilir.

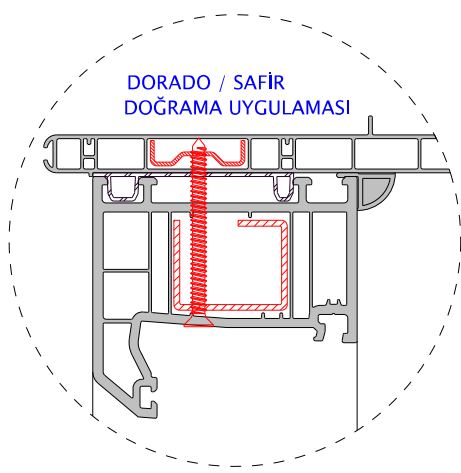

DORADO / SAFİR
DOĞRAMA UYGULAMASI

CARINA
DOĞRAMA UYGULAMASI

* Oval kapatma profilinin takılması ile işlem tamamlanır.

12442 – Panjur Dikme Adaptör 42 mm

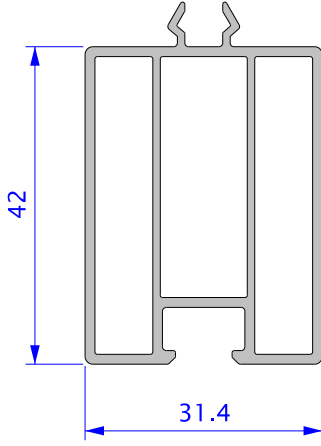
**1. UYGULAMA :**

Panjur ile yapılan stor Sineklik uygulamalarında,
çalışma alanını oluşturacak 42 mm mesafeyi sağlar.

Piyasadaki örnek
standart sineklik

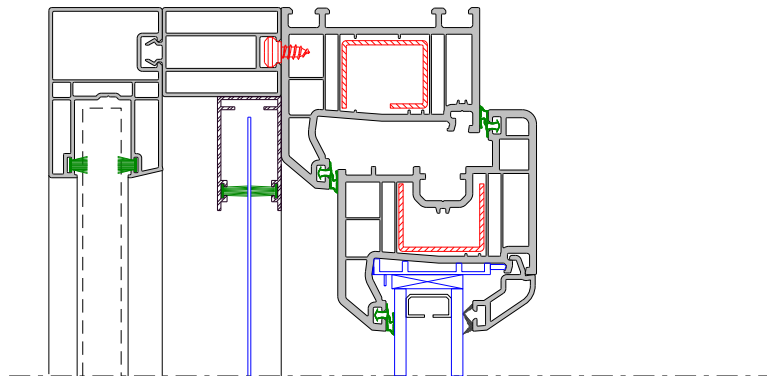
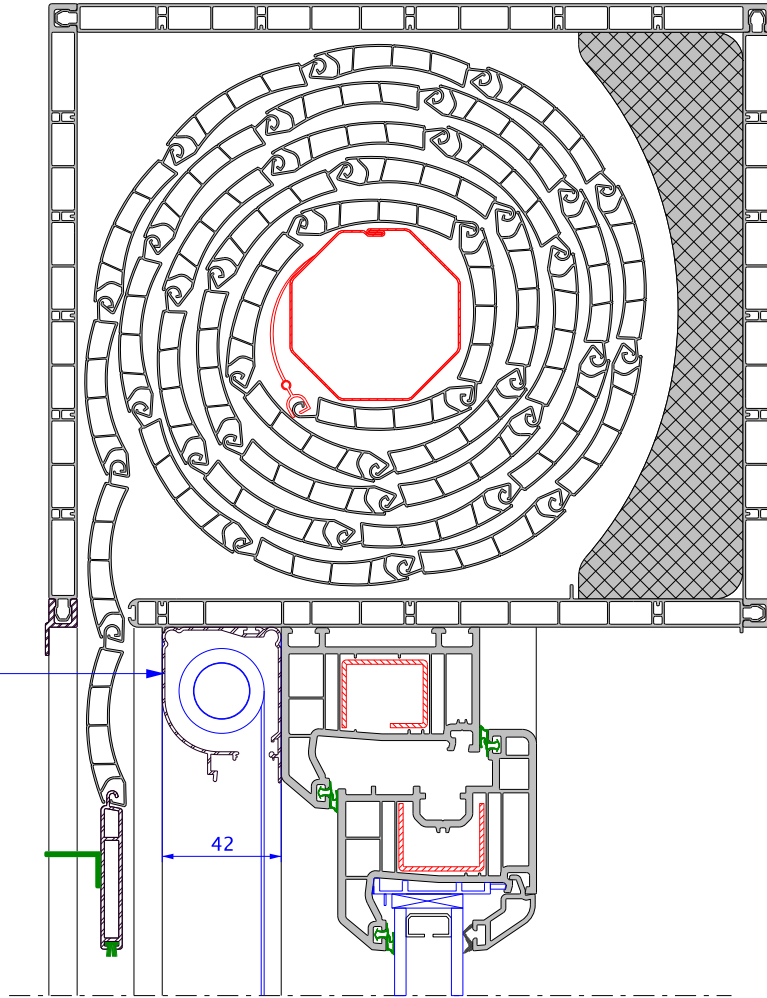

2. UYGULAMA :

42' lik uzatma profili aynı zamanda orta dikme profilleri ile de uyumludur. Gereken 42 mm mesafeyi sağlar.

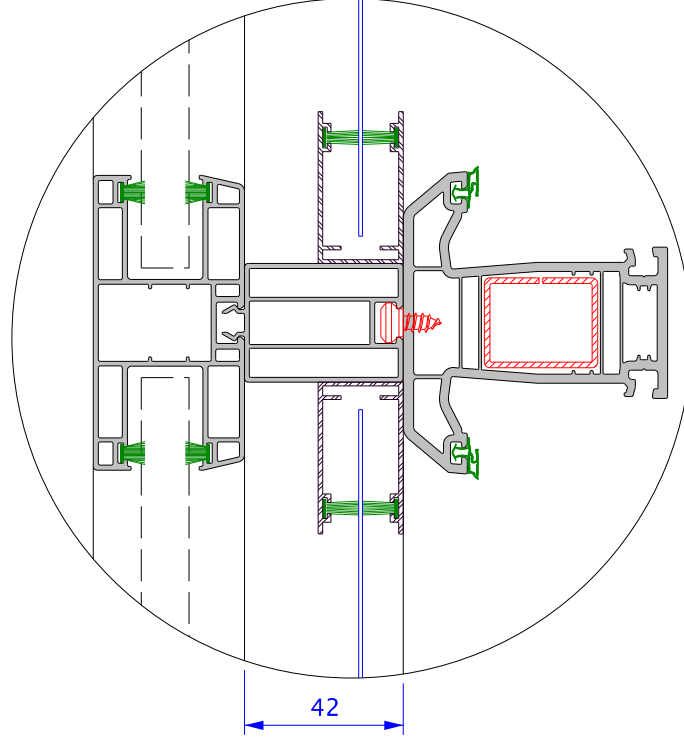
**3. UYGULAMA :**

Stor Sineklik uygulaması dışında, panjurlu kapı uygulamalarında kapı kolunun çarpmasını engellemek amacı ile de 42 mm uzatma kullanılabilir.

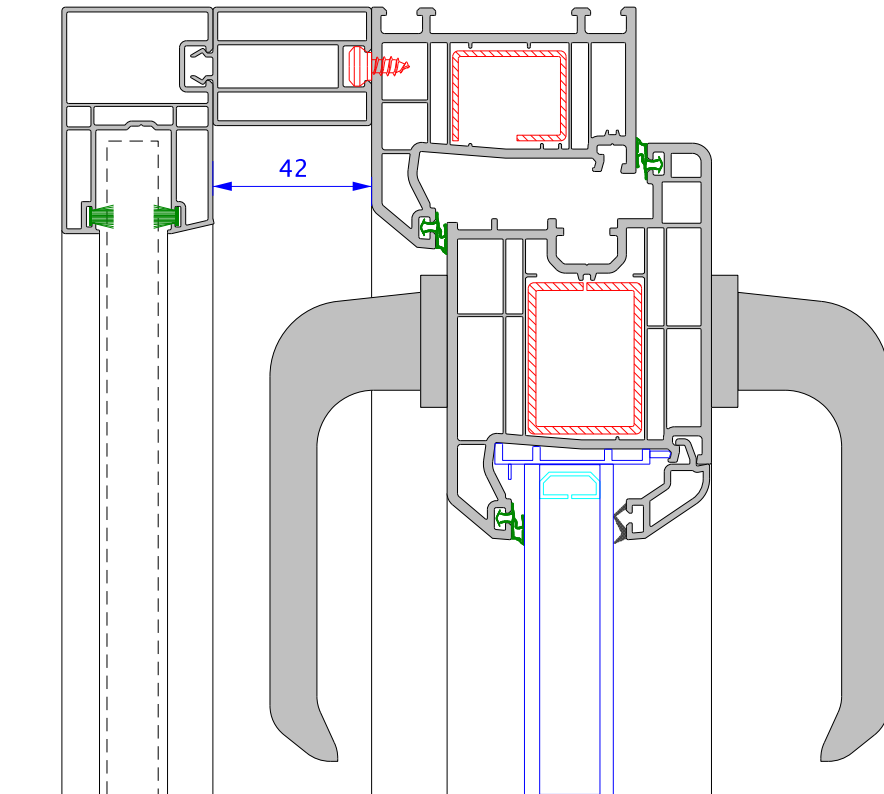

13052 – Uzatmalı Kutu Bitiş Al.

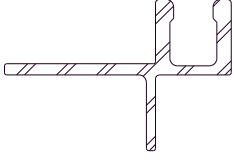

* Gizli Panjur kutusu uygulamalarında, kutunun dışarıdan yapılan izolasyon levhalarının alüminyum kutu bitiş profili üzerine sabitlenmesini sağlar.

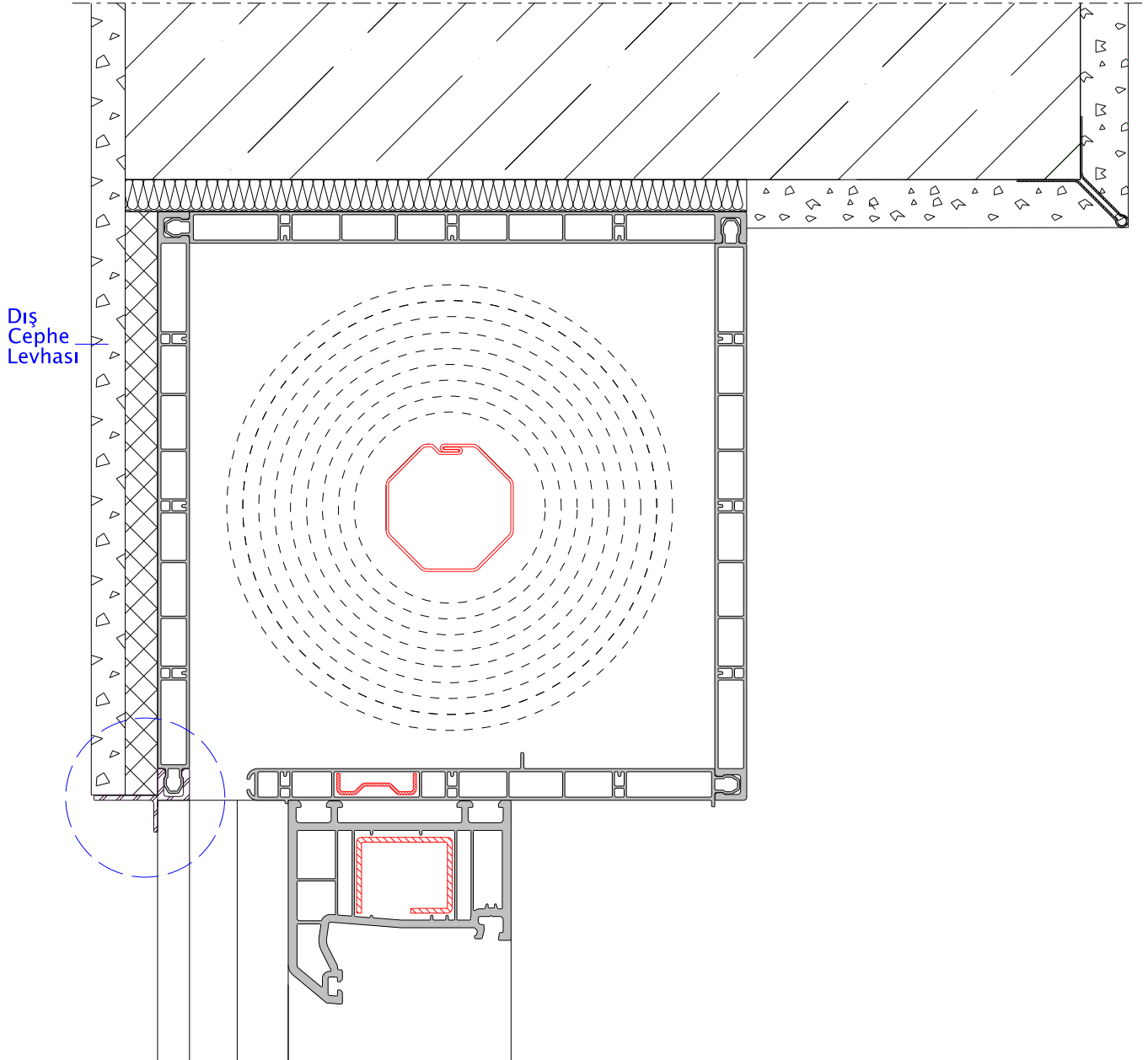

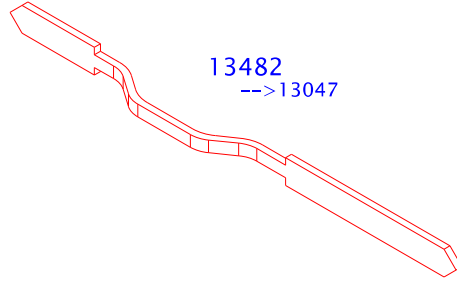
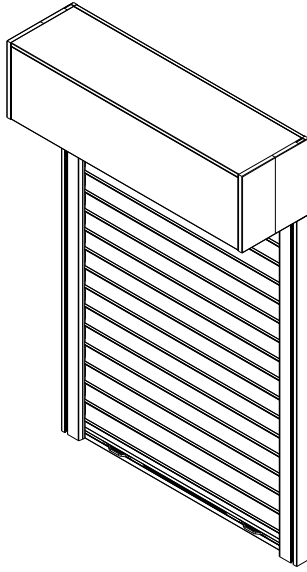
13482
-->13047

12450

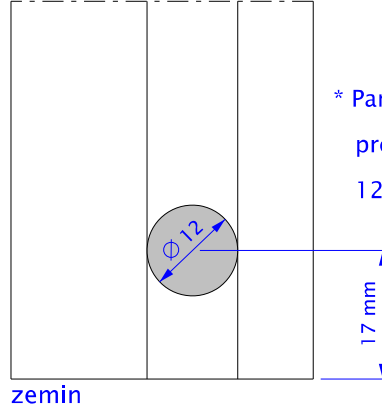

* Panjur yan dikme profili veya orta dikme profilleri, yukarıda ölçüsü verilen yerden 12 mm matkap ucu ile delinir.

1

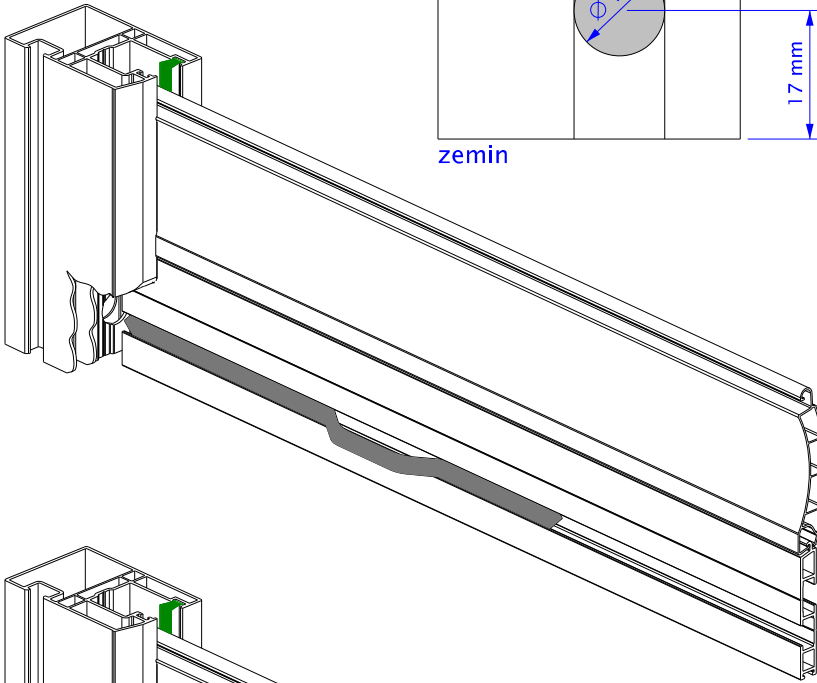

2

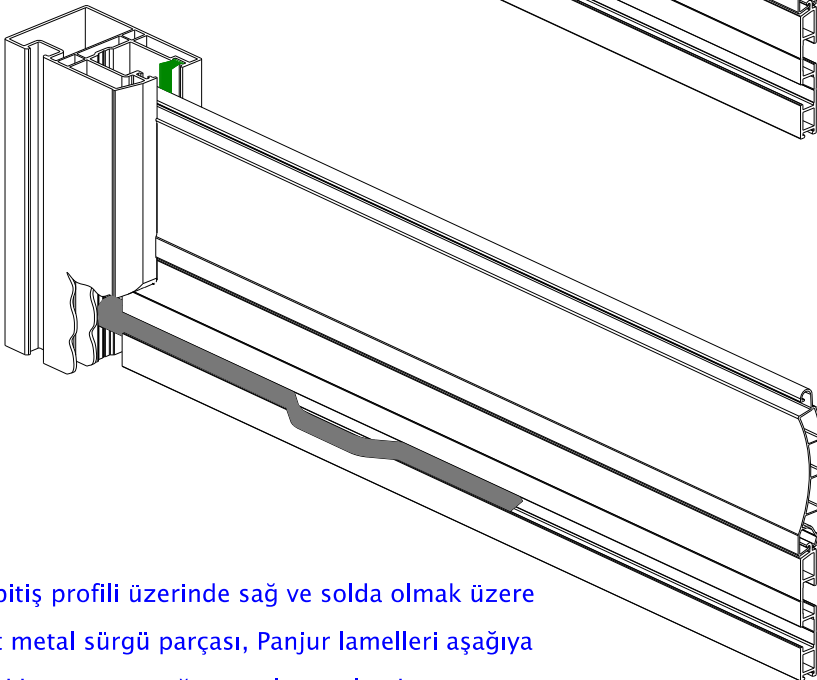

* Kilitli bitiş profili üzerinde sağ ve solda olmak üzere 2 adet metal sürgü parçası, Panjur lamelleri aşağıya indirildikten sonra sağa ve sola sürülerek, yan veya orta dikmelerdeki deliklerin içine sürülerek kilitlenir.

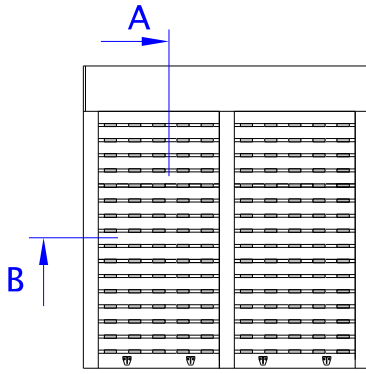

A-KESİTİ

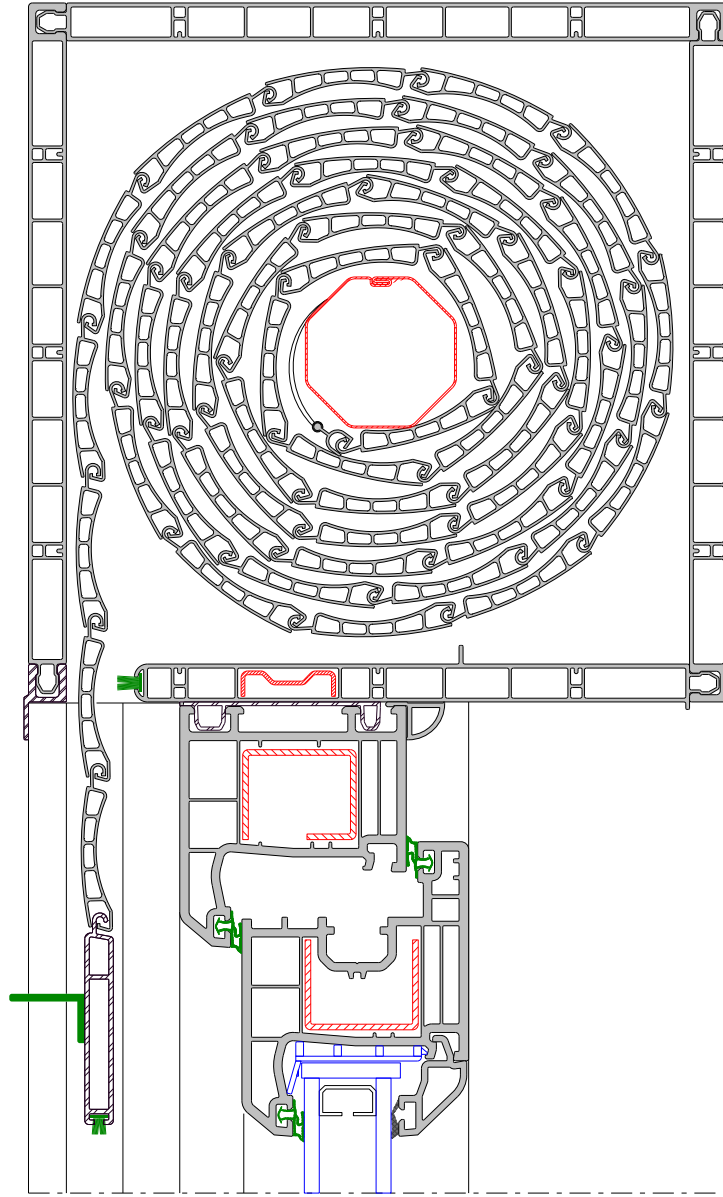

B-KESİTİ

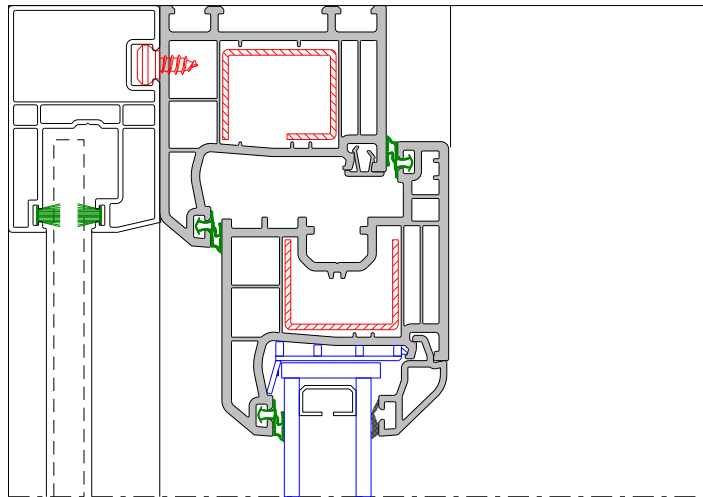

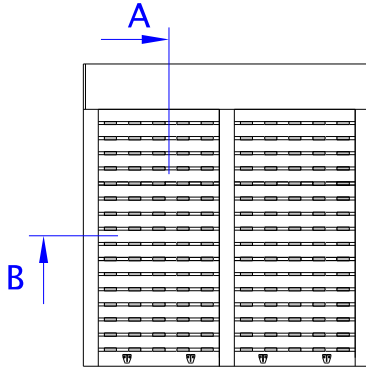

A-KESİTİ

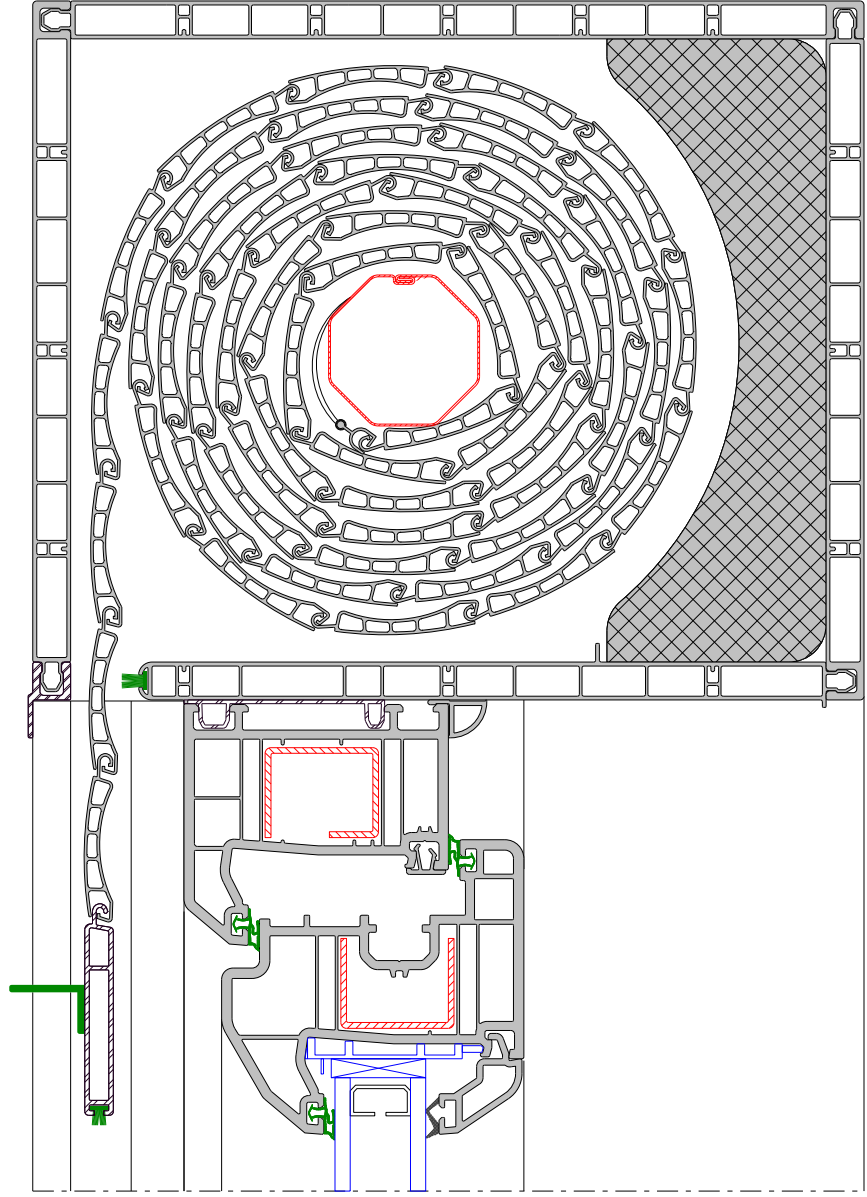

B-KESİTİ

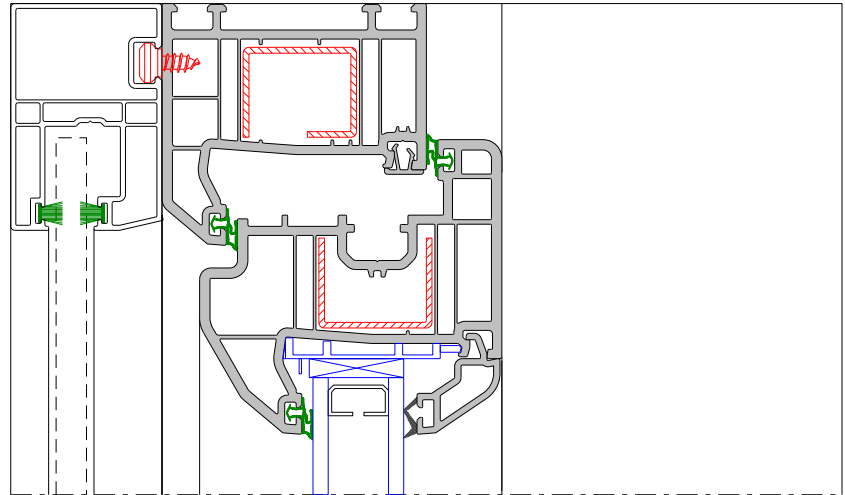

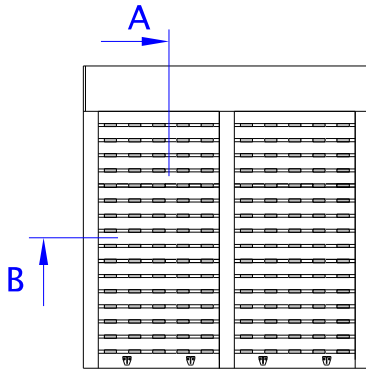

A-KESİTİ

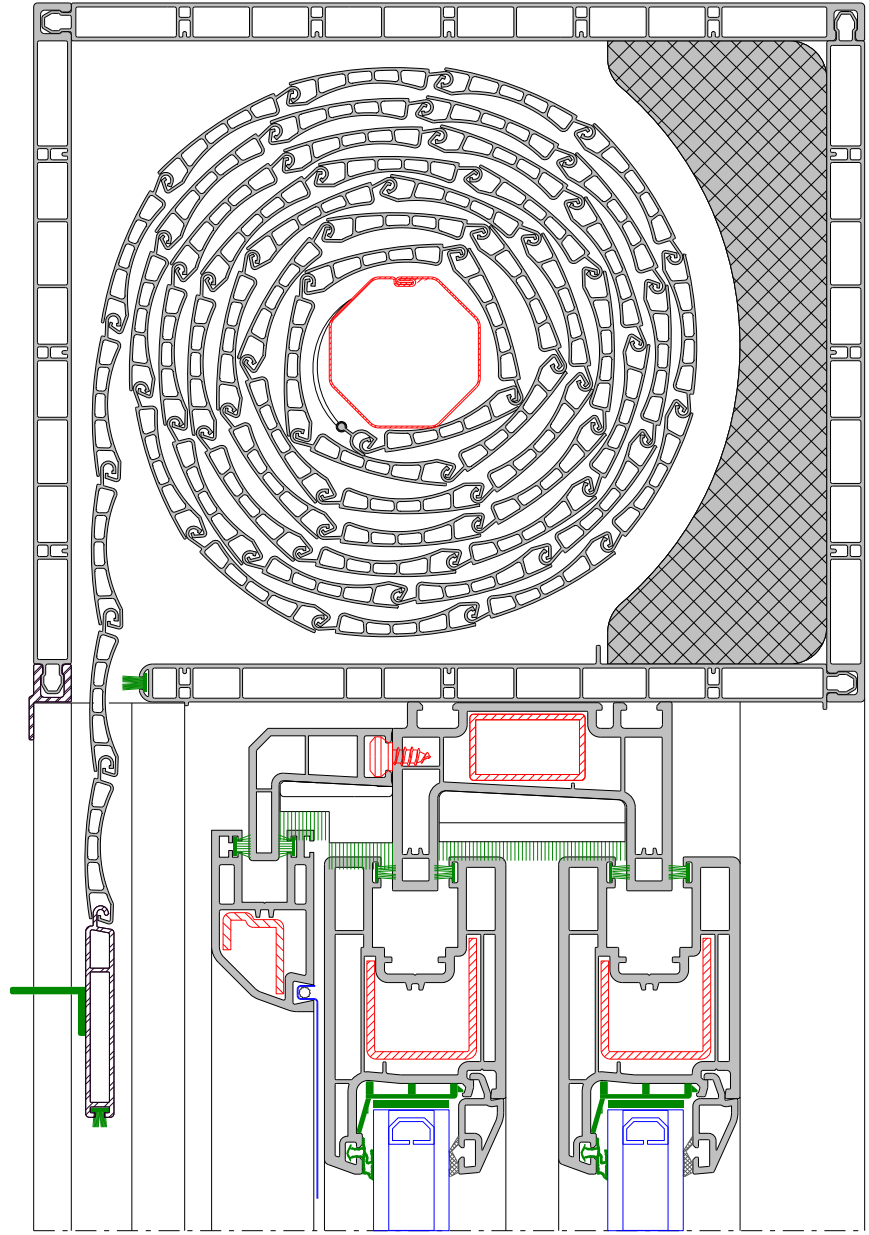

B-KESİTİ

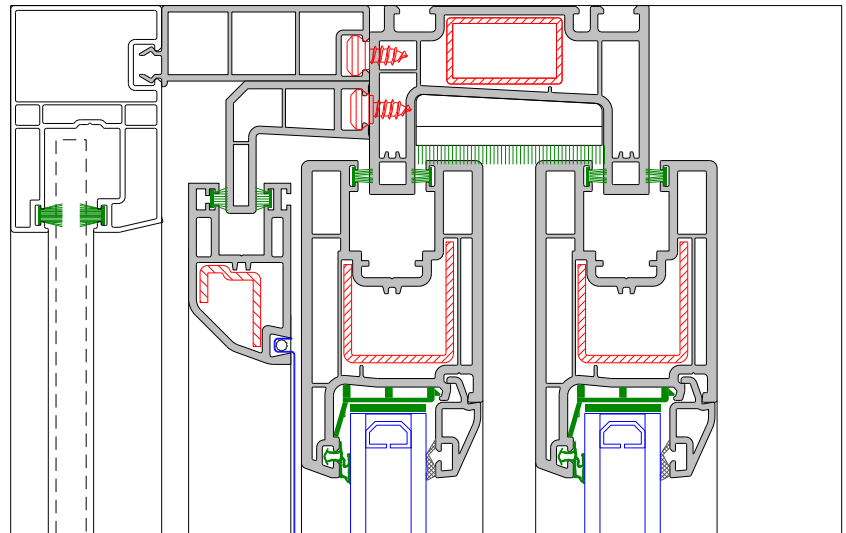

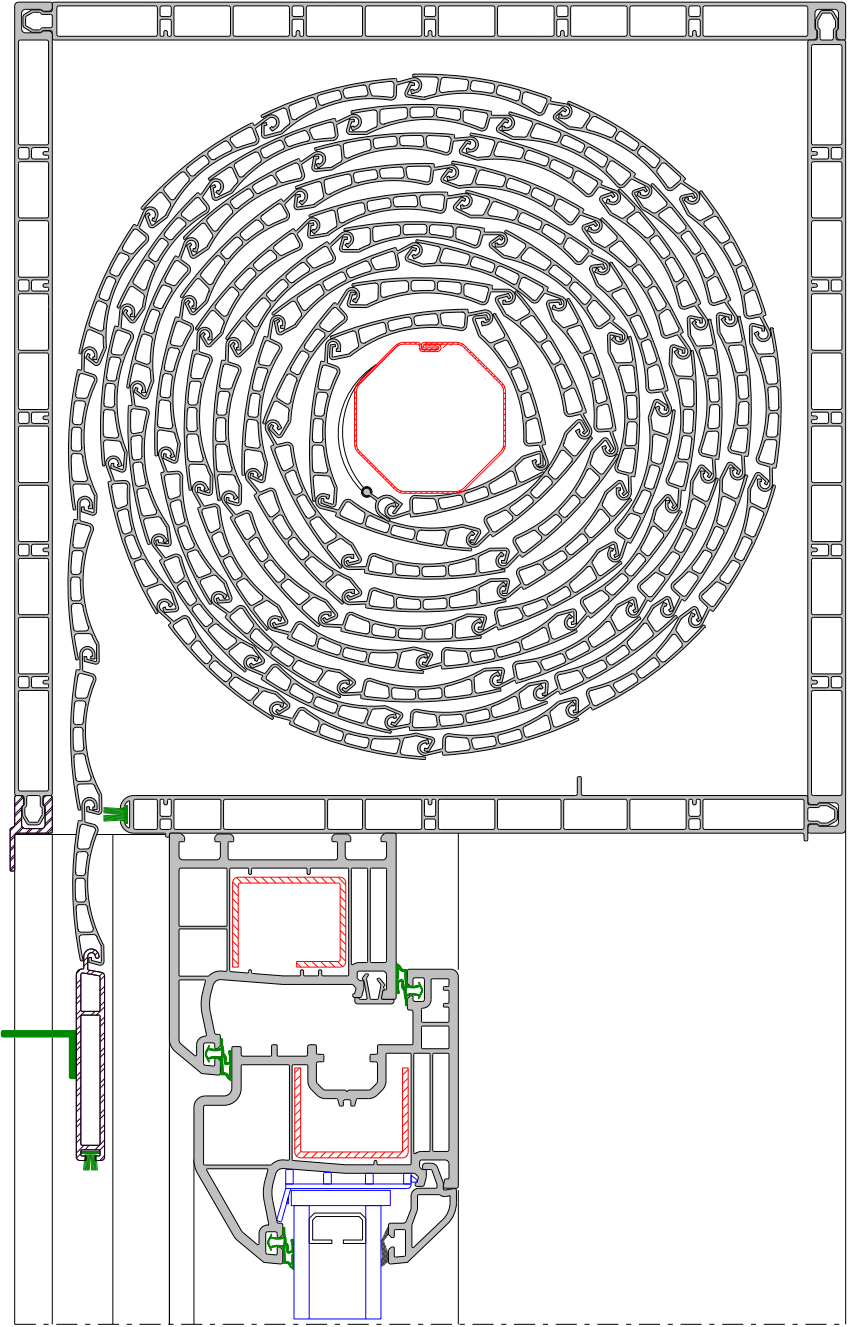
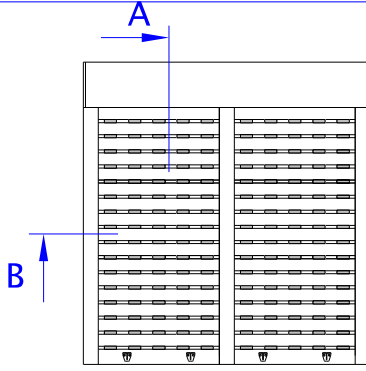

A-KESİTİ

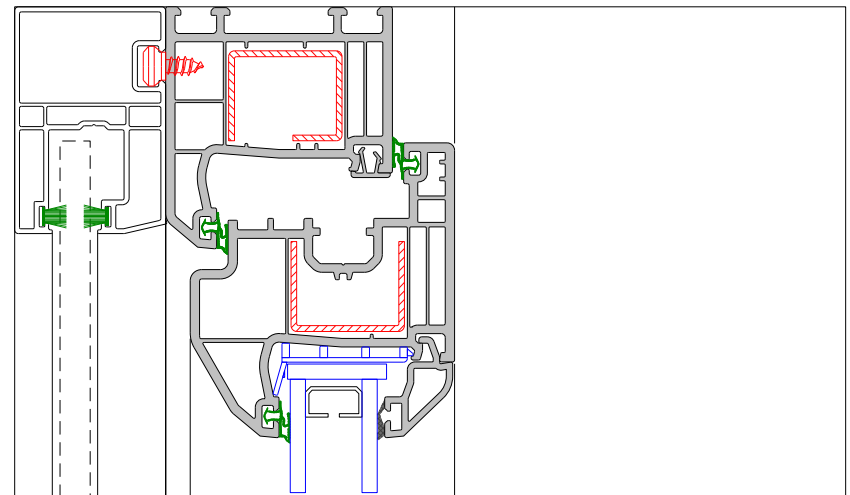

B-KESİTİ

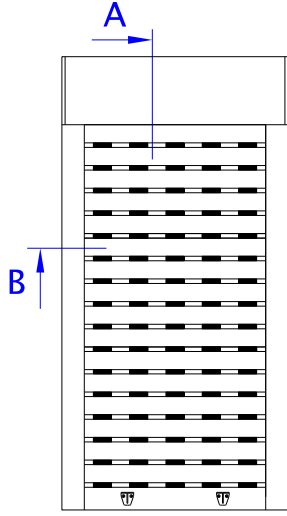

A-KESİTİ

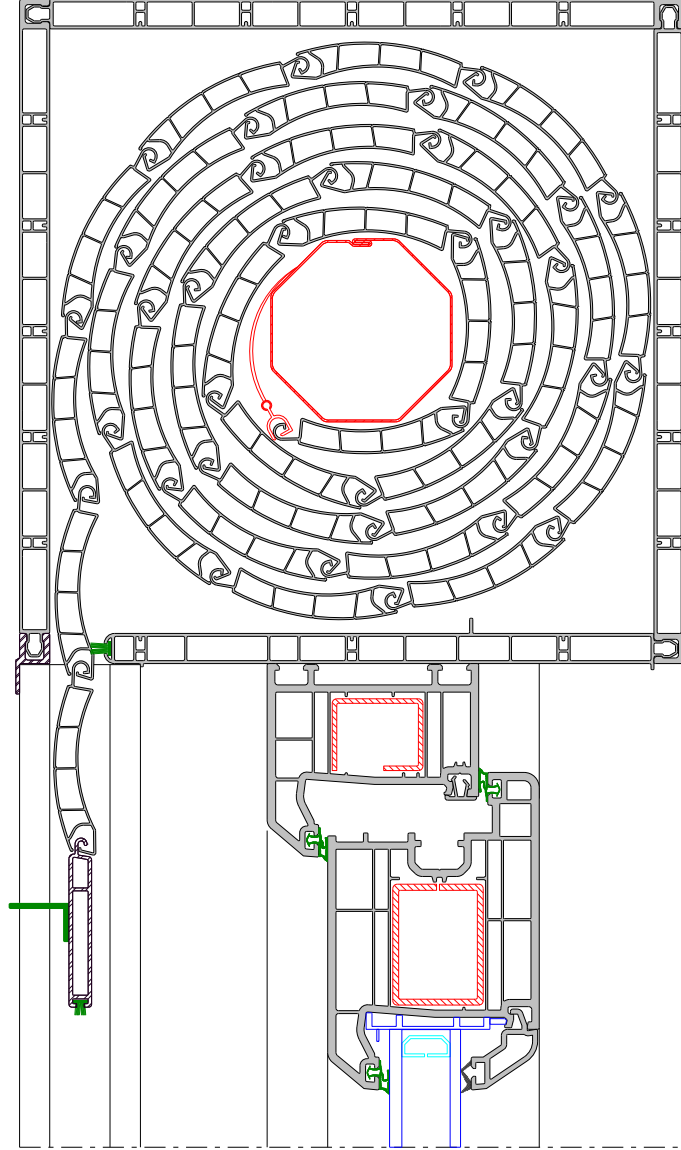

B-KESİTİ

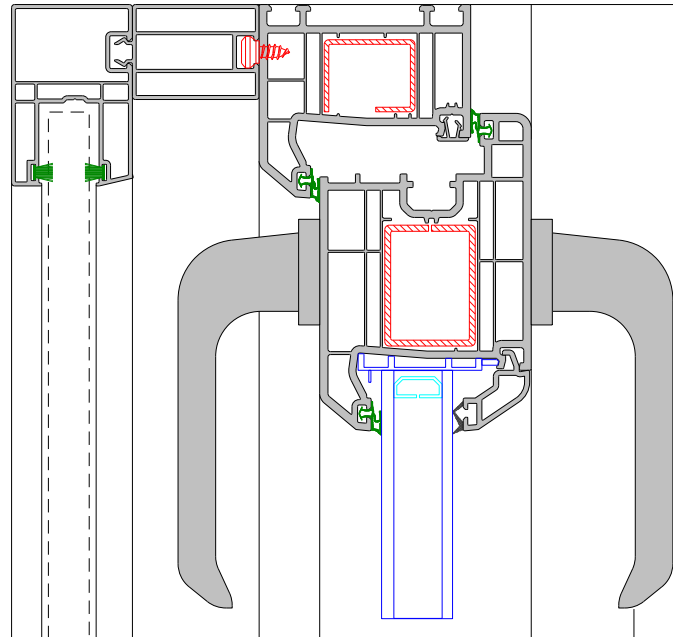

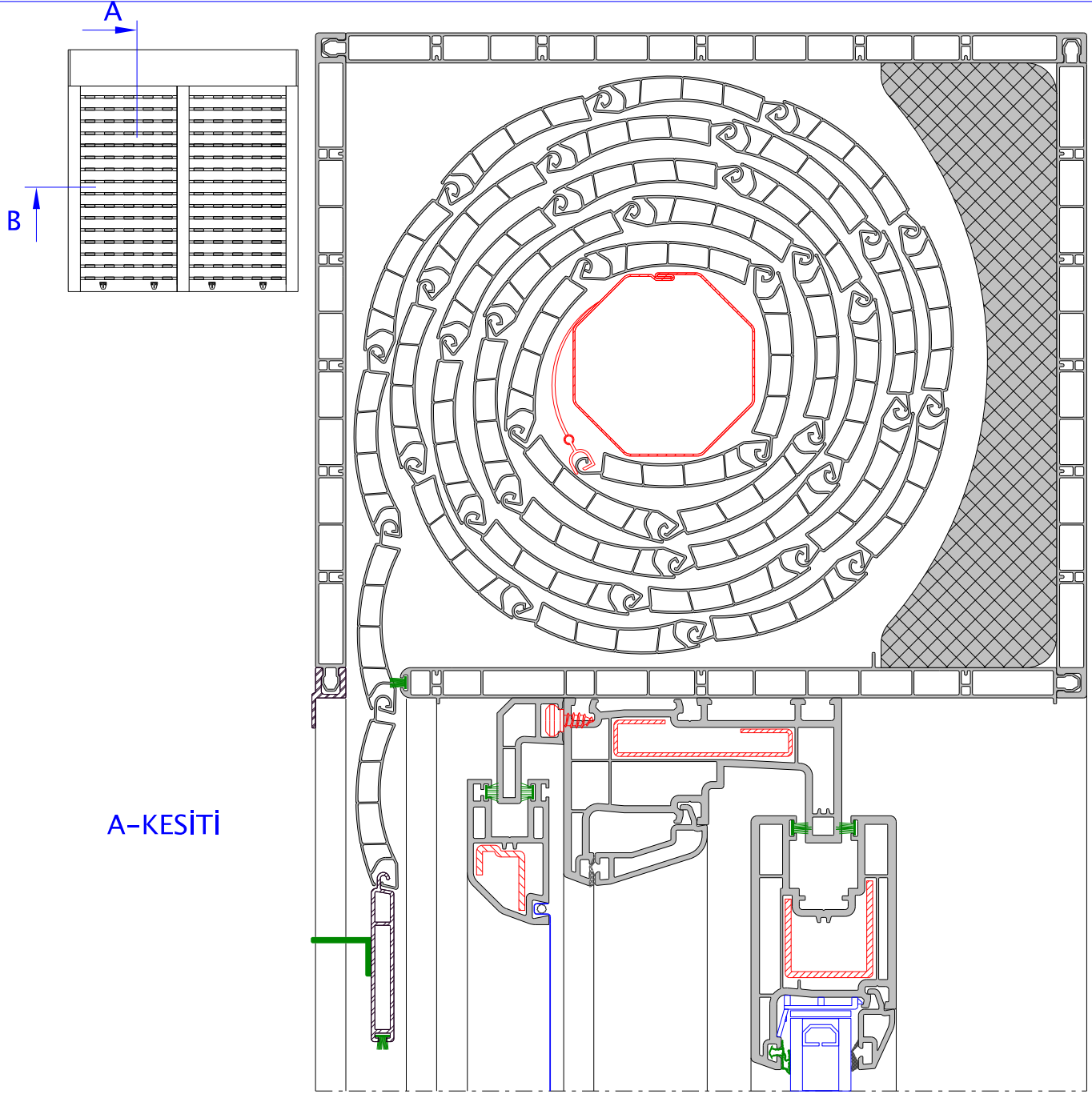

B-KESİTİ

